



**\$349,900**

## **3329 NW BRICKYARD RD, TOPEKA, KS 66618, USA**

<https://askmcgrew.com>

- 3 beds
- 3 baths
- Active
- 2442 sq ft

Welcome to your dream ranch home! This charming residence features fresh interior paint, brand-new carpet, and updated windows, ensuring a bright and inviting atmosphere. Enjoy breathtaking views from the living room, perfect for relaxing or entertaining. The updated bathrooms add modern convenience, while a new roof and septic system provide peace of mind. Set on [...]

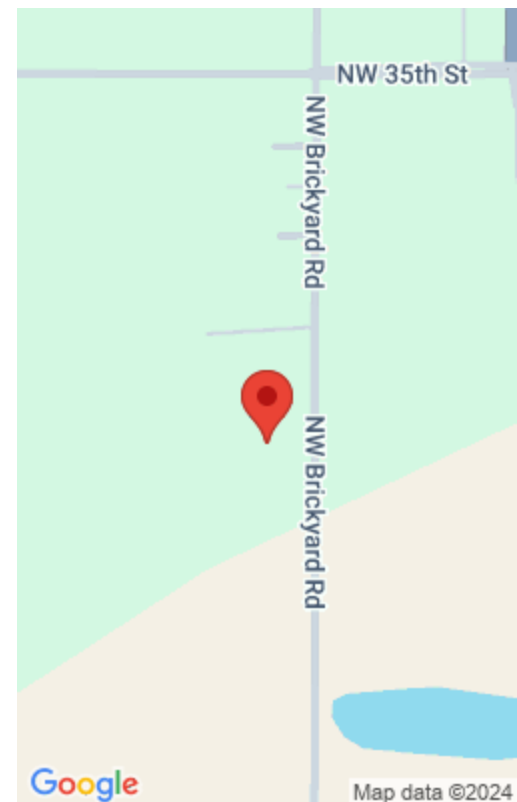

---

## Basics

**Date added:** Added 7 hours ago

**Status:** Active

**MLS ID:** LBR162242

**ArchitecturalStyle:** Ranch

**Half baths:** 1 half bath

**Bathrooms Full:** 1

**Garage:** No

---

## Property Details

**List Office Name:** KW INTEGRITY

**Bedrooms:** 3 beds

**Area, sq ft:** 2442 sq ft

**Basement:** Full, Partially Finished, Walk Out

**Other Structures:** One

**Cooling:** Central Air

**Amenities:** Dishwasher, Electric Range, Microwave, Refrigerator

**Year built:** 1963

**Bathrooms:** 3 baths

**Basement:** Yes

**Roof:** 3D Composition

**Garage Spaces:** 3

**Flooring:** Carpet, Luxury Vinyl Tile

---

## Schools

**High School:** Seaman

